

Area F	Form no. 174
-----------	-----------------

MASSACHUSETTS HISTORICAL COMMISSION



Newburyport

Address 19 Marlboro Street

Historic Name \_\_\_\_\_

Use: Original Residence

Present Residence

Ownership:  Private individual  
 Private organization \_\_\_\_\_

Public \_\_\_\_\_

Original owner Unknown

Draw map showing property's location in relation to nearest cross streets and other buildings or geographical features. Indicate north.

DESCRIPTION:

Date Eighteenth Century

Source Building Fabric

Style Georgian

Architect Unknown

Exterior wall fabric Clapboards, shingles

Outbuildings Garage

Major alterations (with dates) front

entrance altered (date unknown)

Moved \_\_\_\_\_ Date \_\_\_\_\_

Approx. acreage 8,600 sq. ft.

Setting in residential area of

predominantly eighteenth century

single family dwellings adjacent to

the banks of the Merrimack River.

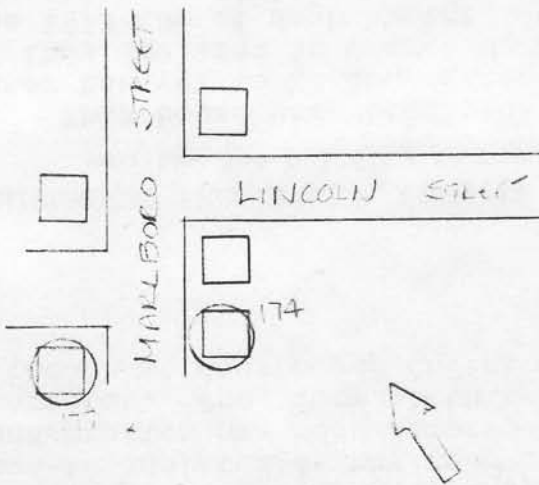

Recorded by Mary Jane Stirgwort

Organization Office of Community Development

Date 11-4-80

ARCHITECTURAL SIGNIFICANCE (describe important architectural features and evaluate in terms of other buildings within community)

This Georgian home with five bay facade and pitched roof has several noteworthy features. These include the large central chimney and the lean-to addition at the rear of the house. The front entrance and the fenestration has been altered but the building retains much of its original character. The form of this house is quite unusual in Newburyport although it does occur in the Joppa district.

HISTORICAL SIGNIFICANCE (explain the role owners played in local or state history and how the building relates to the development of the community)

This house undoubtedly dates from the eighteenth century. The original owner has yet to be documented however. The earliest known proprietor of this dwelling is George W. Woodwell. Woodwell is noted as the owner on the 1872 map of Newburyport. Woodwell is listed as a farmer in the city directory of 1871.

The Woodwells were one of the important families in the shipbuilding industry in the Joppa district of Newburyport. Although George Woodwell was a farmer by trade his predecessors, and possibly the earlier owners of the house were probably shipbuilders. In 1868 George W. Woodwell served as a representative to the General Court from the Sixth Essex district.

BIBLIOGRAPHY and/or REFERENCES

Assessor's Records

J. J. Currier, History of Newburyport 1764-1905, vols. I and II., reprint, Newburyport 1977.

1872 Map of the City of Newburyport, Mass. D. G. Beers and Co.

1872 City Directory